

## Differential Housing Cover

### Material

Item	Specification
Motorcraft® SAE 80W-90 Premium Rear Axle Lubricant XY-80W90-QL (US); CXY-80W90-1L (Canada)	WSP-M2C197-A
Silicone Gasket and Sealant TA-30	WSE-M4G323-A4

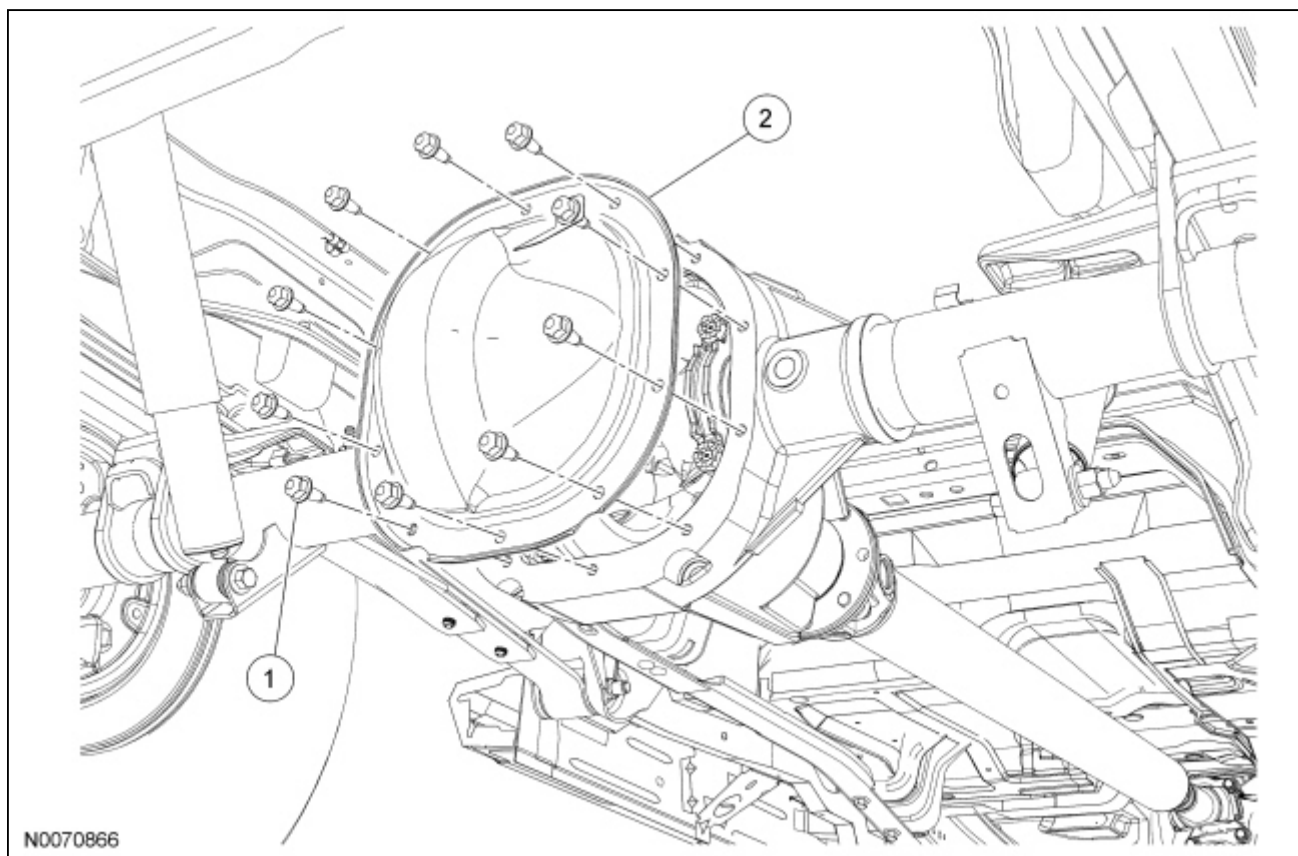

Item	Part Number	Description
1	4346	Differential housing cover bolt (10 required)
2	4033	Differential housing cover

### Removal

1. With the vehicle in NEUTRAL, position it on a hoist. For additional information, refer to [Section 100-02](#).
2. Remove the differential housing cover.
  1. Remove the 10 differential housing cover bolts and drain the lubricant from the axle housing.
  2. Remove the differential housing cover.

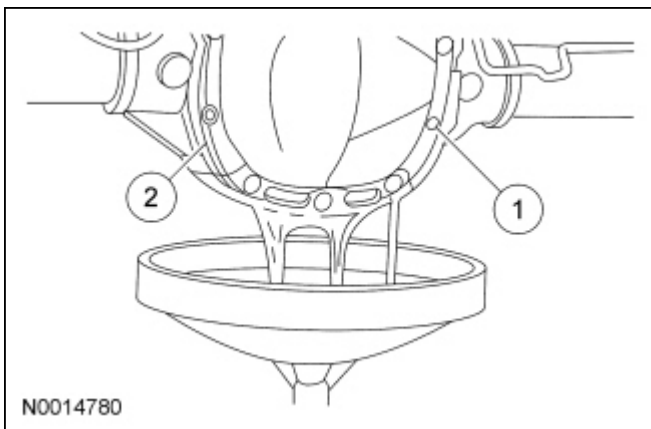

## Installation

1. **NOTE:** Make sure the machined surfaces on both the differential housing and the differential housing cover are clean and free of oil before applying the new silicone sealant. To prevent contamination, cover the inside of the axle prior to cleaning the machined surface.

Clean the differential housing and the differential housing cover gasket mating surfaces.

2. **NOTE:** Install the differential housing cover within 15 minutes of applying the silicone sealant, or it will be necessary to remove and reapply new silicone sealant.

Apply a continuous bead of silicone sealant of the specified thickness to the differential housing cover.

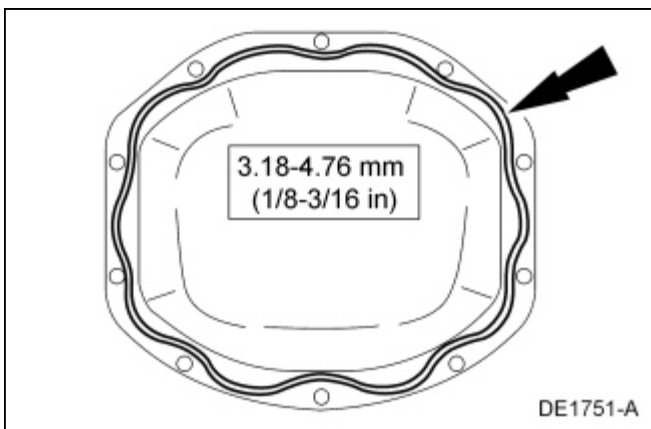

3. **NOTE:** The differential housing cover must be installed within 15 minutes of application of the silicone sealant, or new silicone sealant must be applied. If possible, allow one hour before filling the axle housing with axle lubricant to make sure the silicone sealant has correctly cured.

Install the differential housing cover and the 10 differential housing cover bolts.

- Tighten to 46 Nm (33 lb-ft).

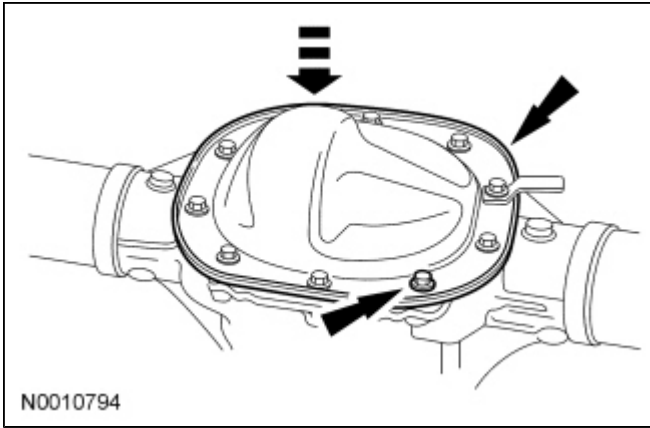

4. **NOTE:** When filling the axle it must be done on a level surface with the vehicle at ride height.

**NOTE:** In-vehicle repair refill capacities are determined by filling the axle with the specified lubricant to 11.1-12.7 mm (0.44-0.50 in) below the bottom of the fill hole.

Remove the axle filler plug, fill the axle to the level shown, approximately 1.42L (3.0 pt) of axle lubricant, and install the filler plug.

- Tighten to 30 Nm (22 lb-ft).

